



[Welcome](#) [Meet Robo C2](#) [Initial set-up](#) [Load filament](#) [Calibration](#) [Test](#)
[print](#) [Connect to Wi-Fi](#) [Next steps](#)

Quick Start Guide

[English](#) [Español](#) [Français](#)

Greetings, Maker... Welcome to the Robo family!

We're thrilled you're here and want to extend a big thank you for your purchase.

Whether the making happens at home, in the workplace or in the classroom, this is the printer engineered to help you unlock the limitless possibilities of your creative potential.



4.6/5

So, go ahead. Make and be proud. Make the amazing. Make it all happen — now.

Make the imagined.

Register your Robo C2

Register your Robo C2 to activate your warranty at:

Welcome Meet Robo C2 Initial set-up
print Connect to Wi-Fi Next steps

robo3d.com/warranty

Service Support

Got questions or need help with your Robo product? Call us anytime — day or night **844-476-2633**

Load filament Calibration Test

Meet Robo C2

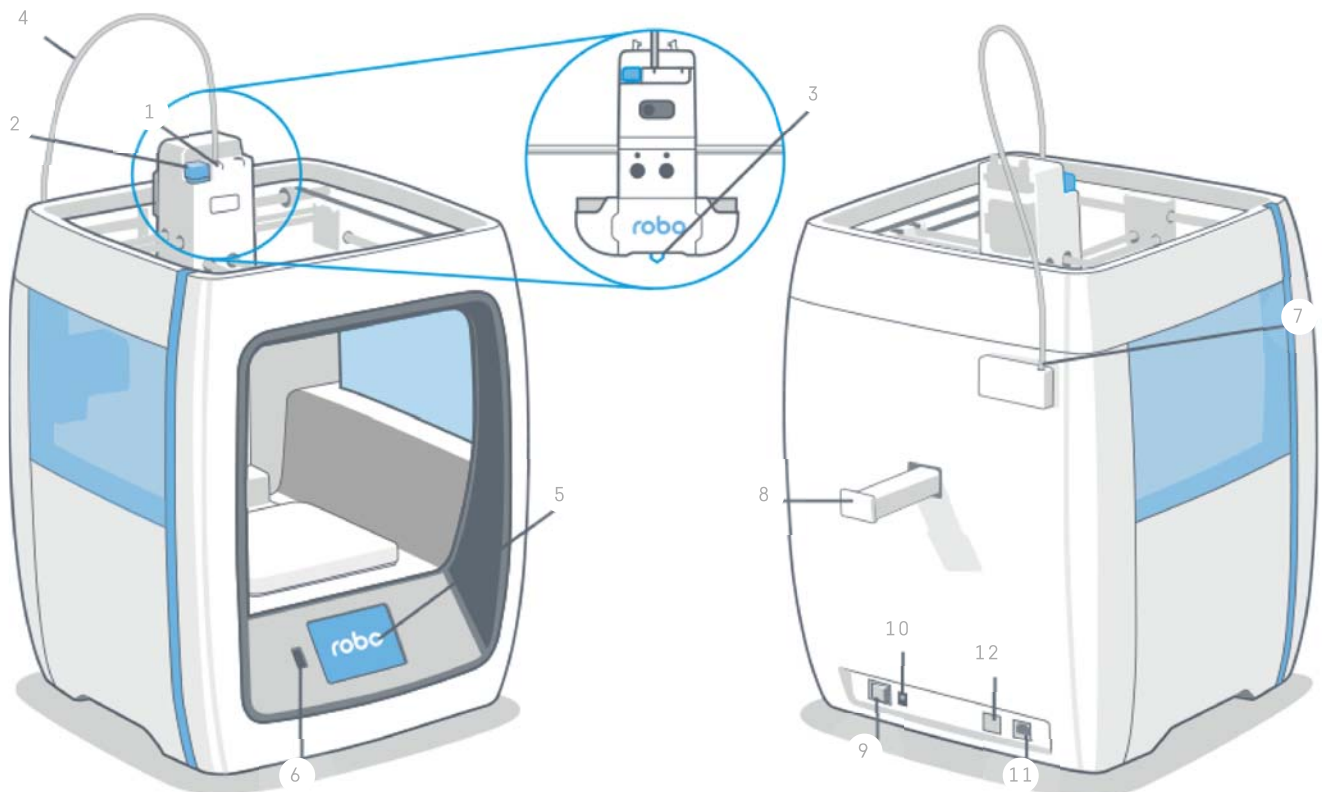

4.6/5

Step 1 Initial set-up



Welcome print Meet Robo C2 Initial set-up Load filament Calibration Test
Connect to Wi-Fi Next steps



1. Insert spool holder into rear slot of Robo C2.



2. Insert filament feed tube into filament sensor block.

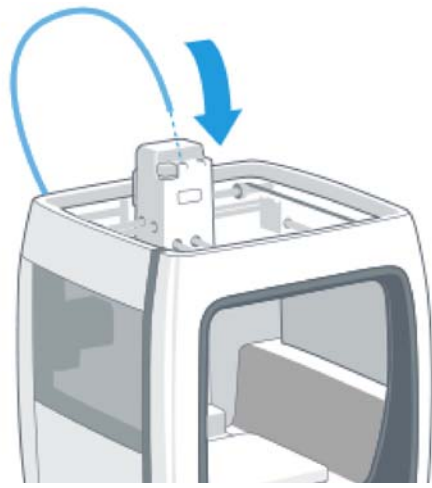

Welcome Meet Robo C2 Initial set-up Load filament Calibration Test
print Connect to Wi-Fi Next steps

3. Insert filament feed tube into extruder.
4. Connect power cord to Robo C2 and AC outlet.
5. Turn on Robo C2.

Step 2 Load filament

1. Hang filament spool onto spool holder.
2. Unroll at least 11" (30 cm) of filament and thread it through base of filament sensor block and into filament feed tube.

3. Continue feeding filament through filament feed tube until it reaches the extruder. Then, press the filament release button to feed filament into the printer's gears.
4. Select **UTILITIES** on touch screen.

Welcome Meet Robo C2 Initial set-up Load filament Calibration Test
print Connect to Wi-Fi Next steps

6. Select **FILAMENT LOADING WIZARD** and follow on-screen prompts.

Step 3 Calibration

1. Select **UTILITIES** on home screen.
2. Select **WIZARDS** from the list.
3. Select **Z OFFSET WIZARD** and follow on-screen prompts.

Step 4 Test print

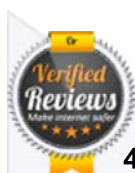

Select **FILES** on home screen. Then select a file to print from the list.

4.6/5

2. Select **START** to print.
3. Wait several seconds while Robo C2 prepares to print the file.
4. The file will start printing. Select **PAUSE** to pause your print. Select **CANCEL** to
Welcome Meet Robo C2 Initial set-up Load filament Calibration Test
print Connect to Wi-Fi Next steps

Step 5 Connect to Wi-Fi

1. Select **UTILITIES** on home screen. Then select a file to print from the list.
2. Select **NETWORK**.
3. Select **CONFIGURE WIFI**.
4. Select your Wi-Fi network.
5. Use on-screen keyboard to enter your password and press **CONNECT**.

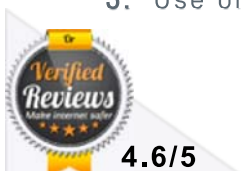

Next steps for total connectivity

Install mobile Robo app

Welcome Meet Robo C2 Initial set-up
print Connect to Wi-Fi Next steps

device and follow



Install desktop software

Load filament Calibration Test

software for Mac
and Windows. Or
download directly
from:

robo3d.com/software

Make more with these awesome online resources

Download high-
quality models
from amazing
designers!

makable.com

thingiverse.com

3dagogo.com

Join the Robo
community —
more tips, tricks
and in-depth
discussions.

community.robo3d.com

Get the latest
news and updates
— and sign-up for
our Robo
newsletter.

robo3d.com

Share everything you make

Connect with @robo3d #robo3d and show the world
what you've got to!

Owner's Manual



4.6/5

To learn more about your Robo C2 and take a closer look at its full capabilities, check out the online

Welcome Meet Robo C2 Initial set-up Load filament Calibration Test
print Connect to Wi-Fi Next steps

nual

© Copyright 2016 | [NEED HELP? Email Us](#) 24/7 Phone Support : [Call 844-476-2633](#)

[TERMS](#) [REFUND POLICY](#) [PRIVACY POLICY](#) [PRESS KIT](#) [CAREERS](#) [INVESTOR RELATIONS](#)
[SITEMAP](#)

